

ONE - COLUMN - 102C1

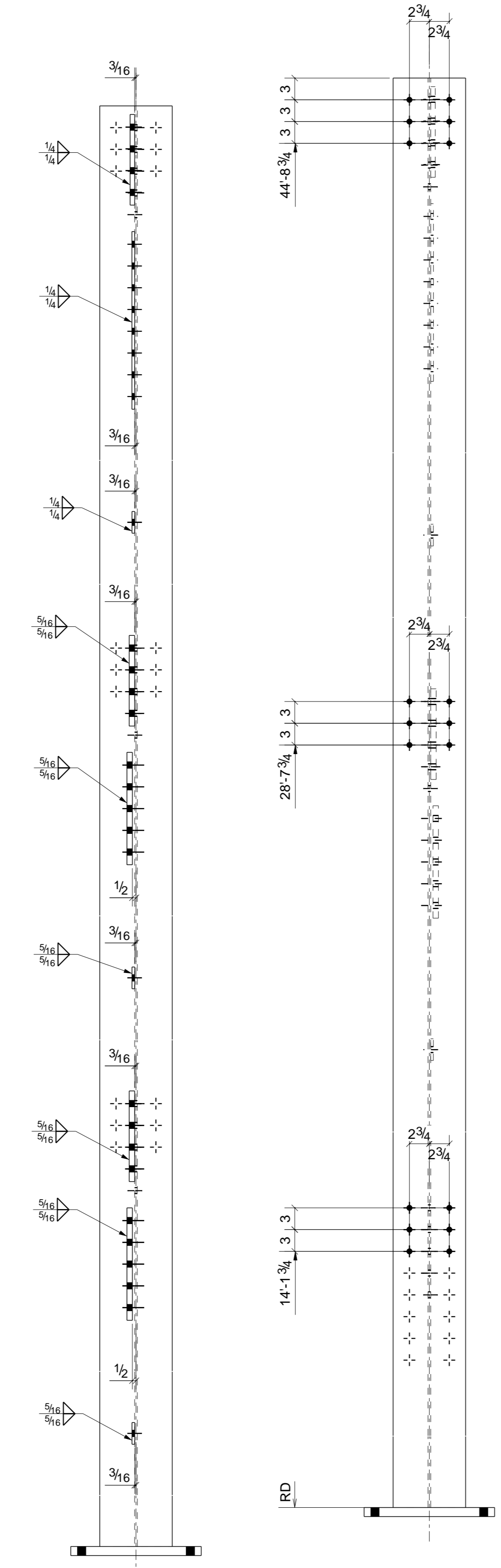

ONE - COLUMN - 102C2

BILL OF MATERIAL					
SHIP MARK	PIECE MARK	QTY	DESCRIPTION	LENGTH	REMARKS
102C1		1	W10X54	45'-5 3/4"	SQ2 A992
	bp4	1	PL1 1/4"X18"	1'-6"	A36
	p8	2	FL3/4"X6 1/2"	1'-0 1/2"	A36
	p9	2	FL3/4"X7 1/2"	1'-3 1/2"	A36
	p63	1	PL5/8"X6 5/8"	1'-0 1/2"	A36
	p104	2	FL3/8"X3"	0'-7"	A36
	p105	1	FL3/8"X3"	0'-7"	A36
	p124	1	FL3/8"X4 1/2"	2'-0 1/2"	A36
102C2		1	W10X54	45'-5 3/4"	SQ2 A992
	bp4	1	PL1 1/4"X18"	1'-6"	A36
	p8	1	FL3/4"X6 1/2"	1'-0 1/2"	A36
	p9	1	FL3/4"X7 1/2"	1'-3 1/2"	A36
	p62	1	PL5/8"X6 5/8"	1'-0 1/2"	A36
	p104	1	FL3/8"X3"	0'-7"	A36
	p105	1	FL3/8"X3"	0'-7"	A36
	p124	1	FL3/8"X4 1/2"	2'-0 1/2"	A36

REV.	DATE	DESCRIPTION	BY	CHKD BY
O	12/01/2014	For Fabrication	JSG	N/A
A	10/29/2014	For Approval	JSG	N/A
OPEN HOLES 13/16" U.N.O.				
PAINT SP3-STD PRIMER				
<b>STATELINE FABRICATORS L.L.C.</b>				
908-387-8800				
ARCHITECT		ENGINEER		P.O. BOX 619 PHILLIPSBURG, NJ
PROJECT NAME		EASTON CITY HALL		
LOCATION		EASTON, PA		
CONTRACTOR		BOYLE CONSTRUCTION		
DESCRIPTION		SHOP DETAILS		
DRAWN BY		JSG	JOB No.	1415
CHECKED BY		N/A	DRG No.	102
APPROVED BY		N/A		