

ONE - BEAM - 106B1

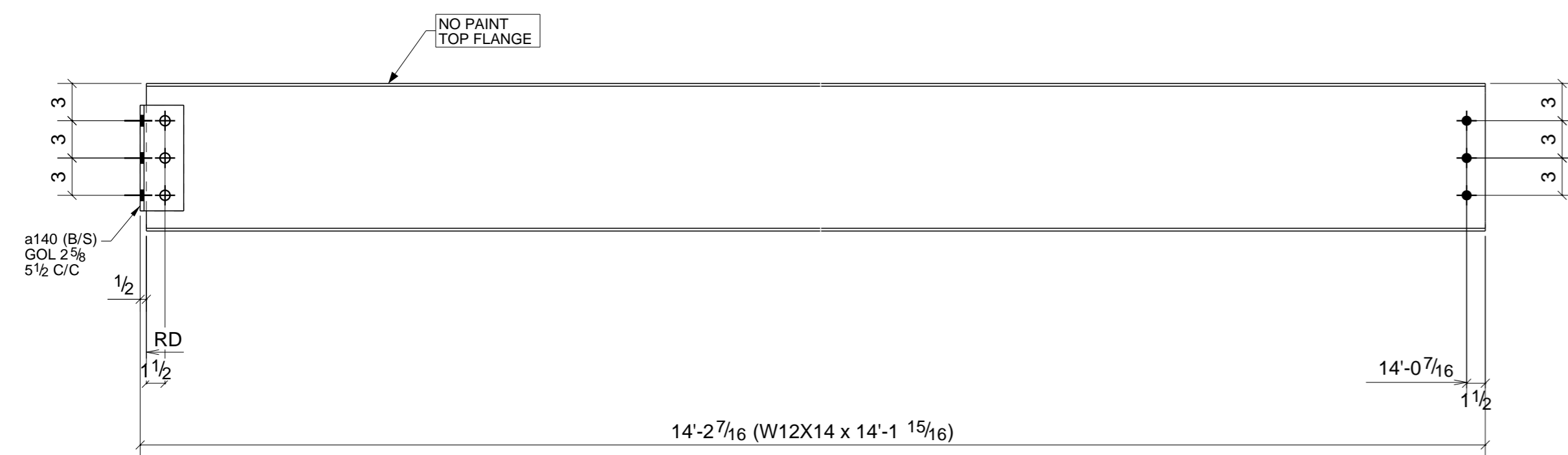

3 - BEAMS - 106B2

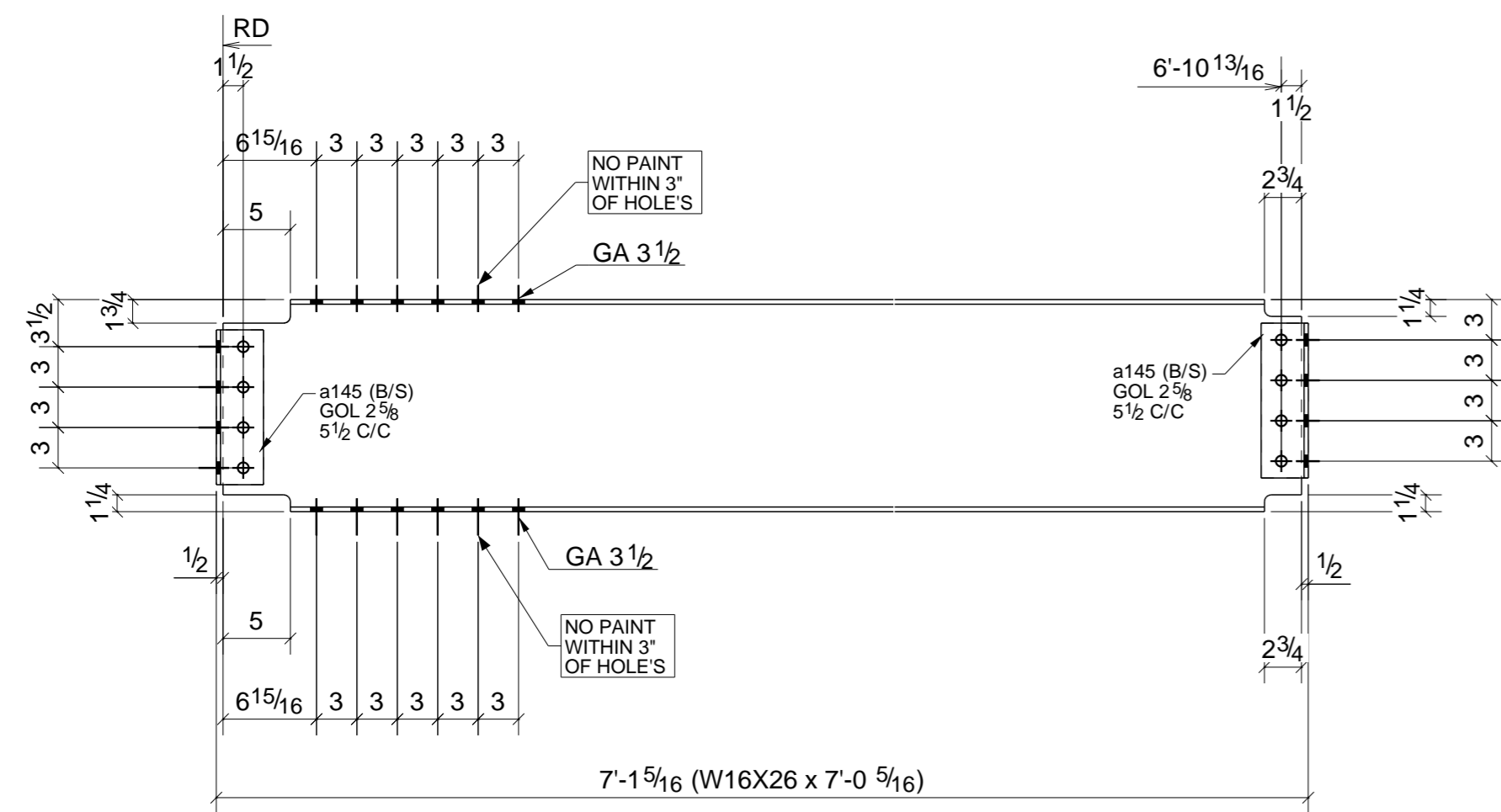

2 - BEAMS - 106B3

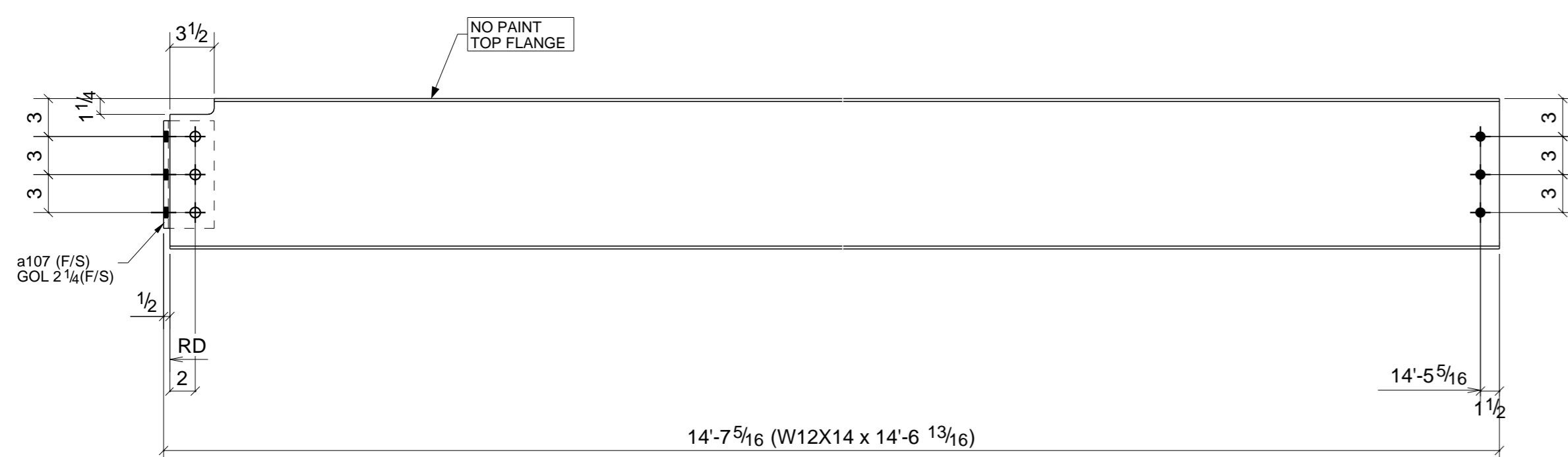

11 - BEAMS - 106B4

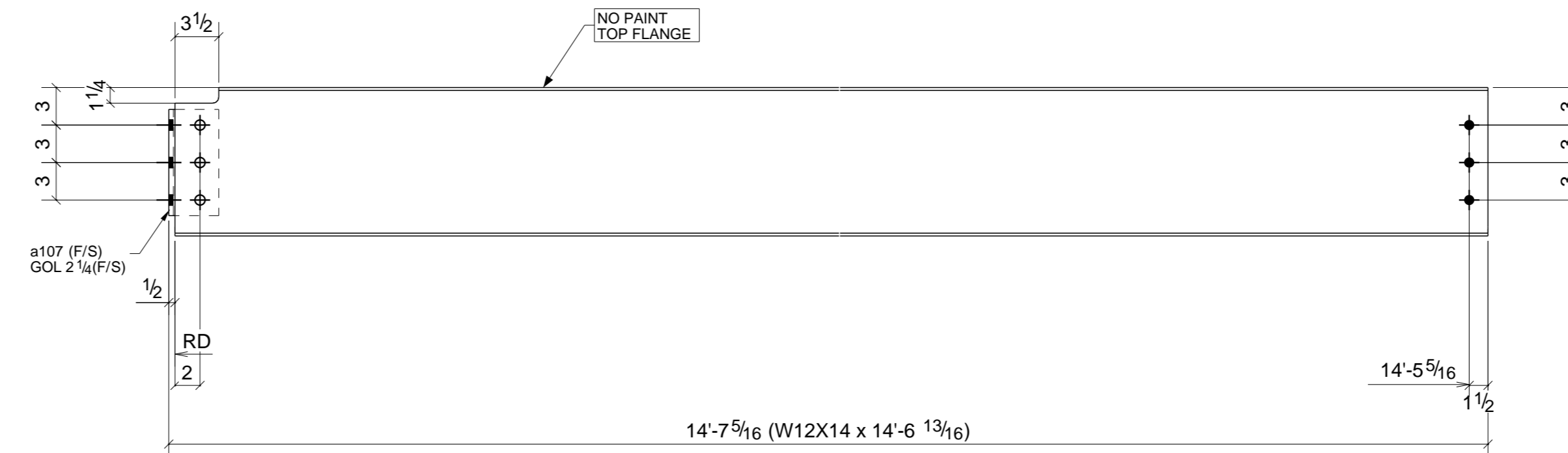

9 - BEAMS - 106B5

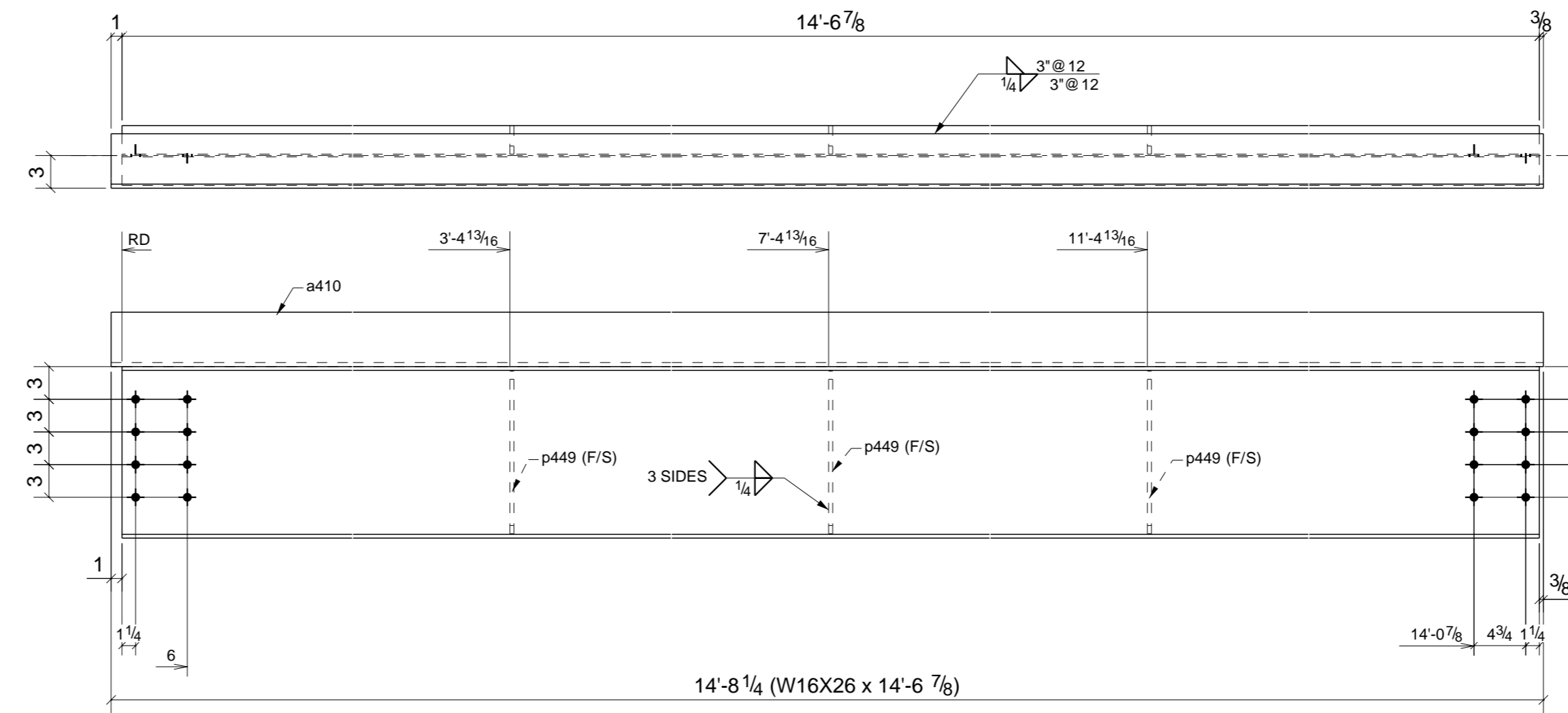

ONE - BEAM - 106B6

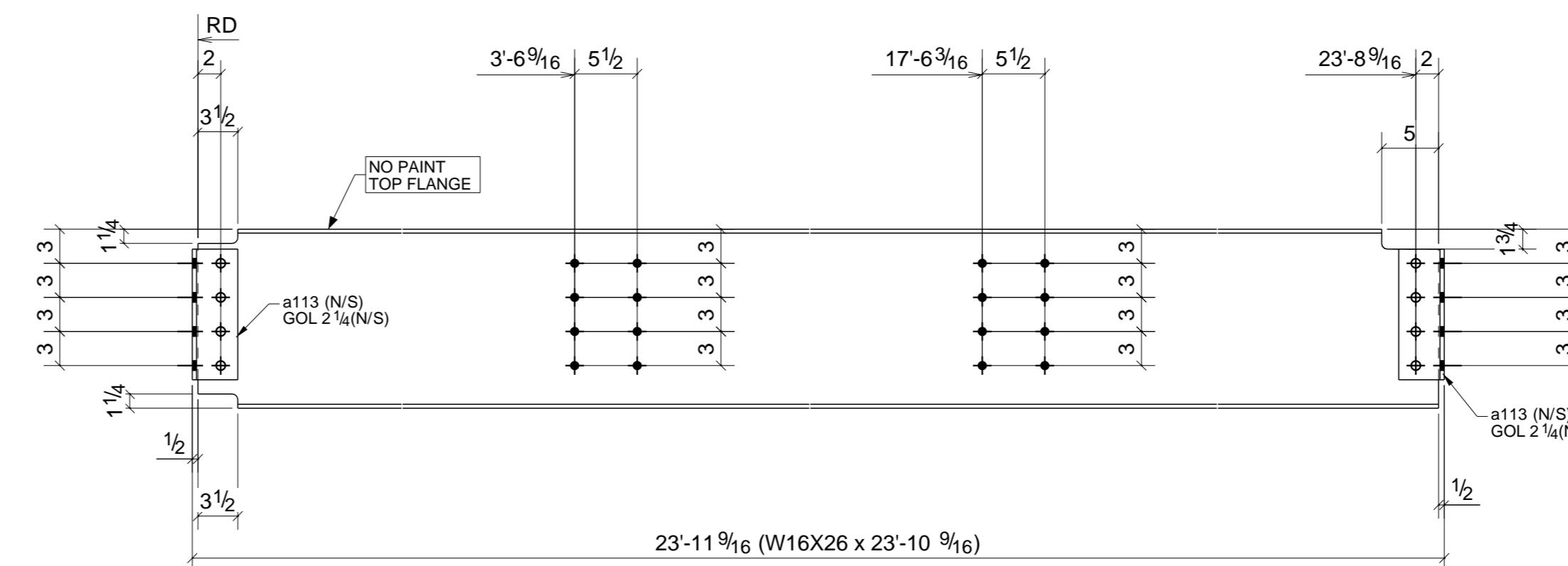

ONE - BEAM - 106B7

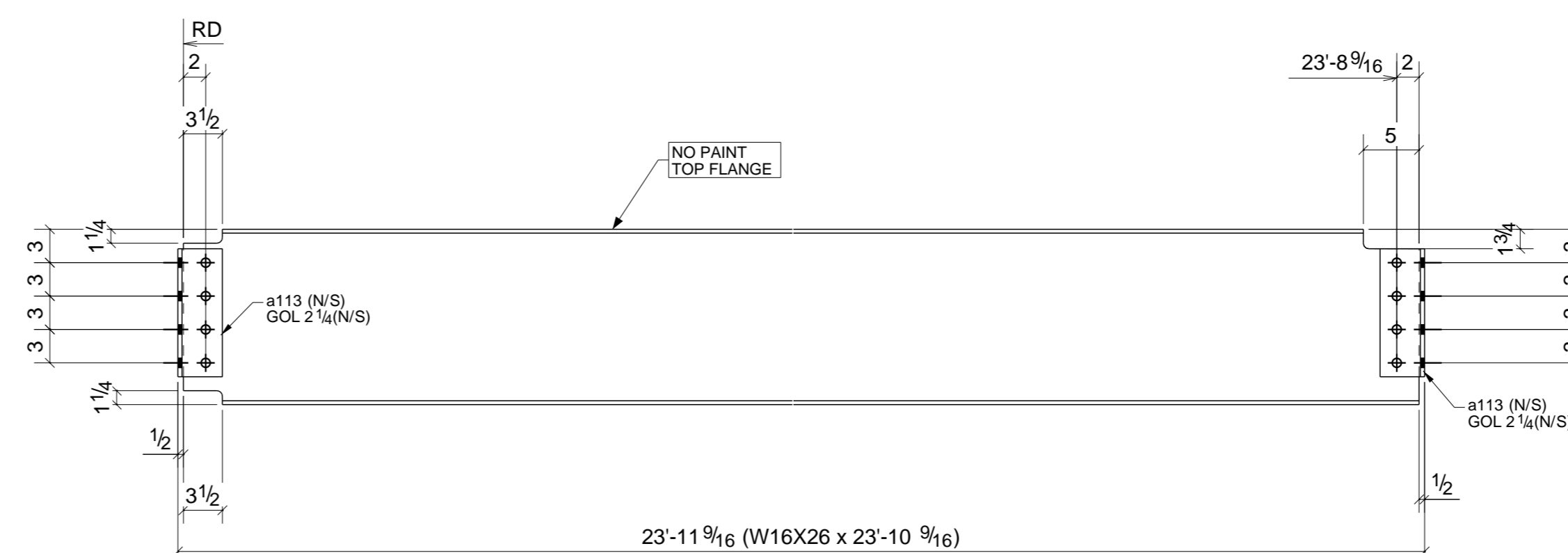

3 - BEAMS - 106B8

BILL OF MATERIAL

SHIP MARK	PIECE MARK	QTY	DESCRIPTION	LENGTH	REMARKS
106B1		1	W16X26	2'-5 9/16"	SQ2 A992
	a81	2	L4X3-1/2X5/16	0'-8 1/2"	A36
	a145	2	L4X3-1/2X5/16	0'-11 1/2"	A36
		7	3/4"Ø A325N BOLT	0'-2"	Workshop
106B2		3	W12X14	14'-11 5/16"	SQ2 A992
	a140	6	L4X3-1/2X5/16	0'-8 1/2"	A36
		9	3/4"Ø A325N BOLT	0'-2"	Workshop
106B3		2	W16X26	7'-0 5/16"	SQ2 A992
	a145	8	L4X3-1/2X5/16	0'-11 1/2"	A36
		16	3/4"Ø A325N BOLT	0'-2"	Workshop
106B4		11	W12X14	14'-6 13/16"	SQ2 A992
	a107	11	L4X3-1/2X3/8	0'-8 1/2"	A36
		33	3/4"Ø A325N BOLT	0'-1 3/4"	Workshop
106B5		9	W12X14	14'-6 13/16"	SQ2 A992
	a107	9	L4X3-1/2X3/8	0'-8 1/2"	A36
		27	3/4"Ø A325N BOLT	0'-1 3/4"	Workshop
106B6		1	W16X26	14'-6 7/8"	SQ2 A992
	a410	1	L5X5X3/8	14'-8 1/4"	A36
	p449	3	PL3/8"X2 5/8"	1'-2 15/16"	A36
106B7		1	W16X26	23'-10 9/16"	SQ2 A992
	a113	2	L4X3-1/2X3/8	0'-11 1/2"	A36
		8	3/4"Ø A325N BOLT	0'-1 3/4"	Workshop
106B8		3	W16X26	23'-10 9/16"	SQ2 A992
	a113	6	L4X3-1/2X3/8	0'-11 1/2"	A36
		24	3/4"Ø A325N BOLT	0'-1 3/4"	Workshop

1	01/15/2015	For Revision	JSG	N/A
0	12/31/2014	For Fabrication	JSG	N/A
A	10/29/2014	For Approval	JSG	N/A
REV.	DATE	DESCRIPTION	BY	CHKD BY

OPEN HOLES 13/16" U.N.O.
PAINT SP3-STD PRIMER

STATELINE FABRICATORS L.L.C.
908-387-8800

ARCHITECT SPILLMAN PENNONI INC. P.O. BOX 619 PHILLIPSBURG, NJ

PROJECT NAME EASTON CITY HALL

LOCATION EASTON, PA

CONTRACTOR BOYLE CONSTRUCTION

DESCRIPTION SHOP DETAILS

DRAWN BY JSG

CHECKED BY N/A

APPROVED BY N/A

JOB No. 1415
DRG No. 106